

OF-CS-ZZ-ZZZ-DFP-AR-063000

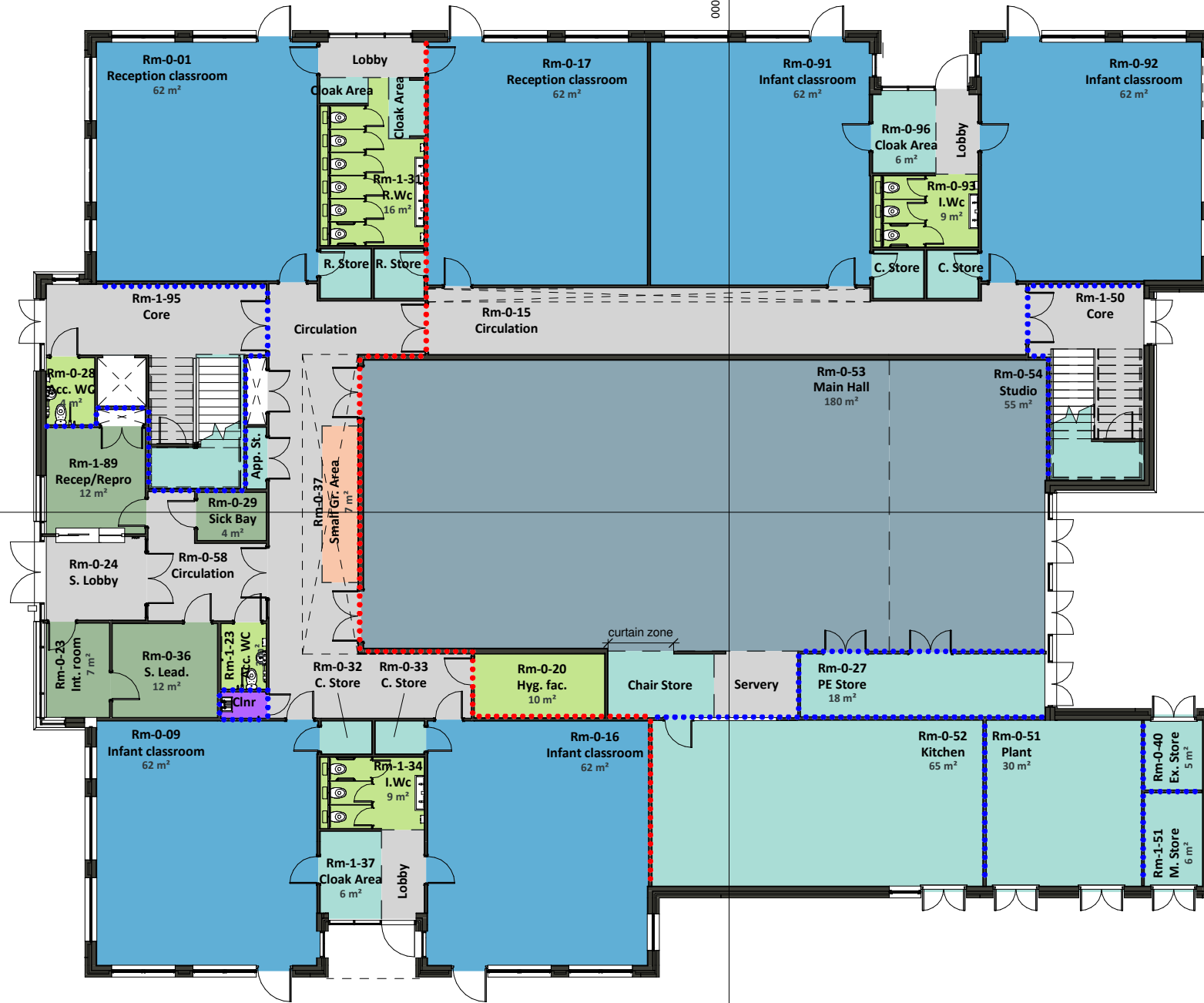

OF-CS-ZZ-ZZZ-DFP-AR-063000

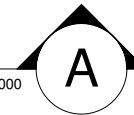

By Department Legend

- Circulation
- General Teaching
- Learning Resource areas
- Multi-purpose Hall
- Riser & Services
- Staff & Admin
- Storage, Kitchen & Plant
- Toilets / WC

P19	Internal door added to Kitchen Rm-0-52 & areas addressed due to software issue	10.11.2015
P18	Areas indicated as per S.O.A.	27.10.2015
P17	Updated for final CP's	27.08.2015
P16	Issued for CP's	22.07.2015
P15	Issued for Planning	17.06.2015
P14	Updated in preparation for the client consultation meeting	05.06.2015
P13	Updated in line with EFA comments	18.05.2015
P12	Issued for EFA Report	11.05.2015
P11	Issue to planners for discussion	05.05.2015
P10	Issue for coordination with design team	30.04.2015
P09	Issue for engagement meeting 08	27.04.2015
P08	First floor plan added to OF-CS-ZZ-U01-DFP-AR-061001. Issue for engagement meeting 07	20.04.2015
P07	Issue for engagement meeting 06	14.04.2015
P06	Initial update following engagement meeting 05 for design team discussion	09.04.2015
P05	Issue for engagement meeting 05	07.04.2015
P04	Possible option issued between meeting 04 and 05	29.03.2015
P03	Issue for engagement meeting 04	23.03.2015
P02	Issue for engagement meeting 04	23.03.2015
P01	Issue for engagement meeting 03	17.03.2015
P00	Issue for engagement meeting 02	09.03.2015

Purpose of Issue

Contractors Proposals

CAPITA
Property and Infrastructure

Ty Menter, Unit G1, The Willowford, Treforest, CF37 5BF

www.capitasymonds.co.uk Capita Symonds Ltd.

Registered office: 71 Victoria Street, Westminster, London, SW1H 0XA. Registered in England and Wales No. 2018542 Part of the Capita Group Plc. www.capita.co.uk



Oakfield Primary School

Ground Floor Plan

Scale @ A3
1 : 200

Drawn
JD

Checked
AJ

Approved
CT

Project No.
CS 079378

Date
05.03.15

Drawing Identifier
OF-CS-ZZ-G00-DFP-AR-061000

BS1192 / Uniclass Compliant
project origin zone level file type role unclass number revision

P19